

Preparation

**Part Number: PT954-35240 (Short Bed)
PT954-35241 (Long Bed)**

Kit Contents

Item #	Quantity Reqcd.	Description
1	1	Hard Folding Cover Assembly
2	1	Bed Cover Rail Assembly Left/Driver Side
3	1	Bed Cover Rail Assembly Right/Passenger Side

Hardware Bag Contents

Item #	Quantity Reqcd.	Description
1	4	Elevator Bolt
2	8	Rubber Washer
3	4	Small Aluminum Spacer
4	4	Lock Washer
5	4	Nut
6	4	R-Clips
7	8	Bed Rail Clamp (5' Bed)
8	8	Screw for Bed Rail Clamp (5' Bed)
9	10	Bed Rail Clamp (6' Bed)
10	10	Screw for Bed Rail Clamp (6' Bed)
11	4	Buckle
12	4	Threaded Post
13	4	Threaded Post Screw
14	2	Buckle Strap
15	2	Storage Buckle
16	8	Pan Head Screw
17	2	Drain Tube
18	2	Drain Tube Adapter
19	2	Block Bumper

Additional Items Required for Installation

Item #	Quantity Reqcd.	Description
1		
2		
3		

Conflicts

Spare Tire Carrier; Bed Rack, Sport Bar, Bed Mat

Recommended Tools

Personal & Vehicle Protection	
Safety Glasses	
Safety Gloves	
Special Tools	Notes
Installation Tools	Notes
Philips screwdriver	
T-30 Torx Driver	
3/8" Drive Short Extension	
1/2" Socket	
Ratchet Wrench	
Knife or Scissors	
Isopropyl alcohol wipe	
Special Chemicals	Notes

General Applicability

MY24 and newer Tacoma, Tacoma HV

Recommended Sequence of Application

Item #	Accessory
1	Tonneau Cover
2	

*Mandatory

Vehicle Service Parts for 5' Bed

Item #	Part Number	Description
1	PT954-35240-LH	Rail Assembly LH Std. (5')
2	PT954-35240-RH	Rail Assembly RH Std. (5')
3	PT954-35240-AA	Clamp Kit - Tacoma
4	PT954-34221-AC	Latch Assembly
5	PT954-35240-AC	Rail End Cap Kit
6	PT954-34221-AE	Prop Rod Clip
7	PT954-34240-TT	Double E-Bolt Hardware Kit
8	PT954-34221-AG	Drain Tubes Kit
9	PT954-34221-AH	Foam Kit
10	PT954-34221-AK	Buckle Kit
11	PT954-34221-AM	Drain Cap
12	PT954-34221-AN	Drain Tube Adapter
13	PT954-34224-AR	A-Panel Bumpers

Vehicle Service Parts for 6' Bed

Item #	Part Number	Description
1	PT954-35241-LH	Rail Assembly LH Std. (6')
2	PT954-35241-RH	Rail Assembly RH Std. (6')
3	PT954-35240-AA	Clamp Kit - Tacoma
4	PT954-34221-AC	Latch Assembly
5	PT954-35240-AC	Rail End Cap Kit
6	PT954-34221-AE	Prop Rod Clip
7	PT954-34240-TT	Double E-Bolt Hardware Kit
8	PT954-34221-AG	Drain Tubes Kit
9	PT954-34221-AH	Foam Kit
10	PT954-34221-AK	Buckle Kit
11	PT954-34221-AM	Drain Cap
12	PT954-34221-AN	Drain Tube Adapter
13	PT954-34224-AR	A-Panel Bumpers

Legend

 **STOP:** Damage to the vehicle may occur. Do not proceed until process has been complied with.

 **OPERATOR SAFETY:** Use caution to avoid risk of injury.

 **CAUTION:** A process that must be carefully observed in order to reduce the risk of damage to the accessory/vehicle and to ensure a quality installation.

 **TOOLS & EQUIPMENT:** Used in Figures calls out the specific tools and equipment recommended for this process.

 **REVISION MARK:** This mark highlights a change in installation with respect to previous issue.

 **SAFETY TORQUE:** This mark indicates that torque is related to safety.

 **REGULATORY MARK:** This mark indicates the component is related to regulatory compliance.



Care must be taken when installing this accessory to ensure damage does not occur to the vehicle. The installation of this accessory should follow approved guidelines to ensure a quality installation.



These guidelines can be found in the "Accessory Installation Practices" document.

This document covers such items as:

- Vehicle Protection (use of covers and blankets, cleaning chemicals, etc.).
- Safety (eye protection, rechecking torque procedure, etc.).
- Vehicle Disassembly/Reassembly (panel removal, part storage, etc.).
- Electrical Component Disassembly/Reassembly (battery disconnection, connector removal, etc.).

Please see your Toyota dealer for a copy of this document.

Kit Contents

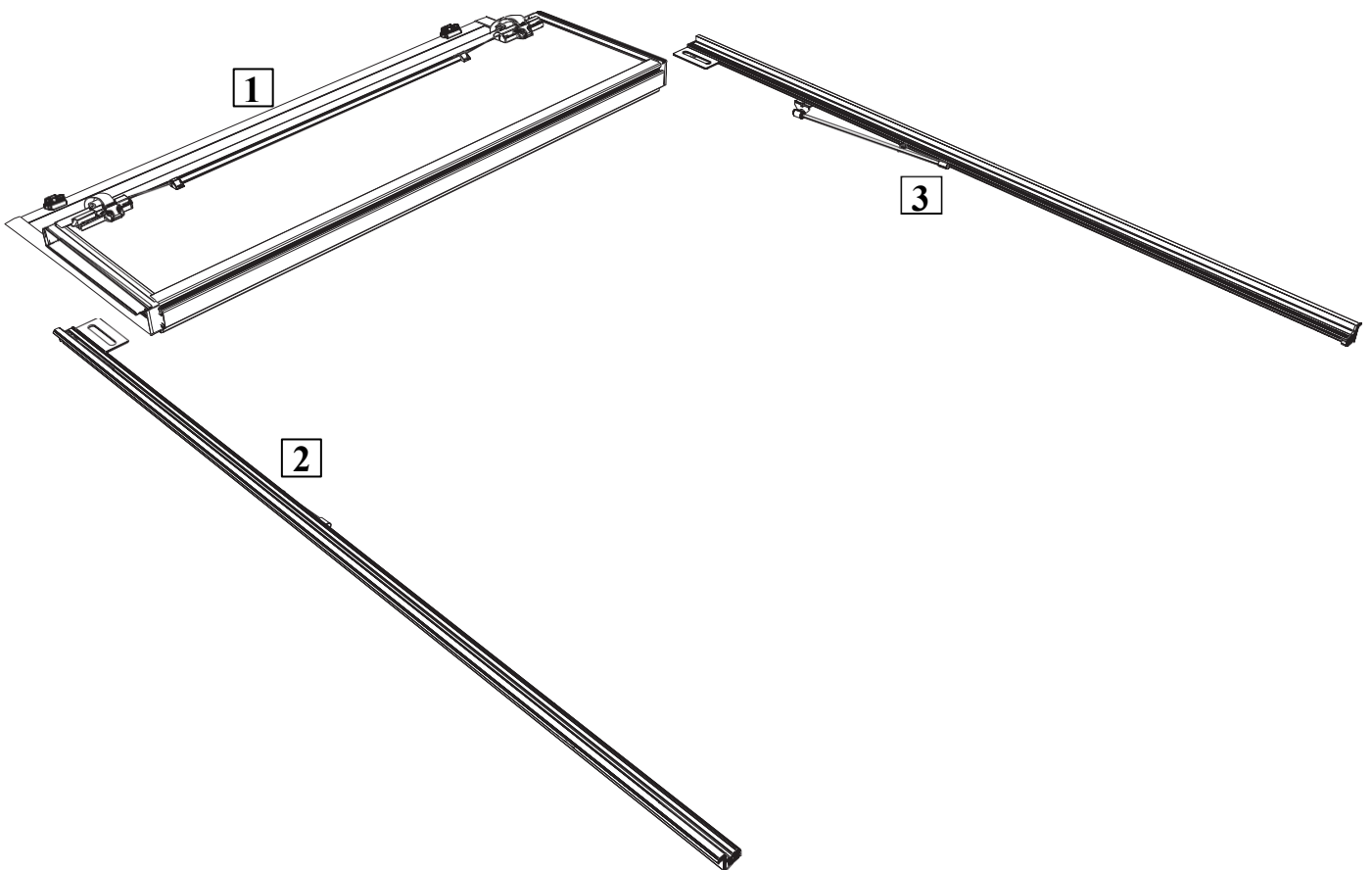

Hardware Bag Contents

234B0101 (5' - 8 Clamps)
234B0102 (6' - 10 Clamps)

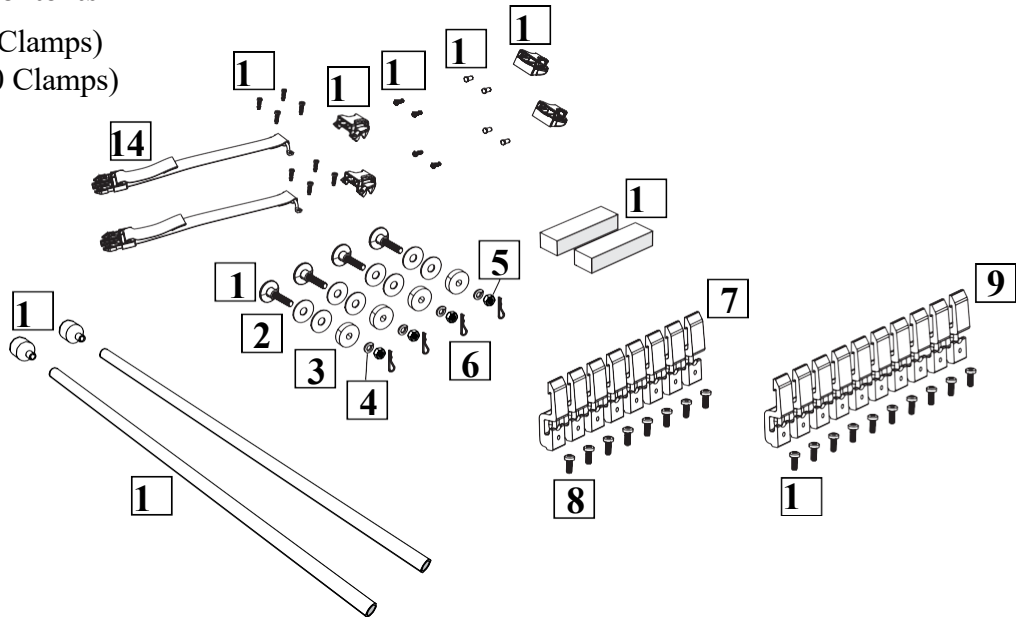

Vehicle Service Parts for 5' & 6' Bed



Care must be taken when installing this accessory to ensure damage does not occur to the vehicle.



The installation of this accessory should follow approved guidelines to ensure a quality installation.

These guidelines can be found in the "Accessory Installation Practices" document.

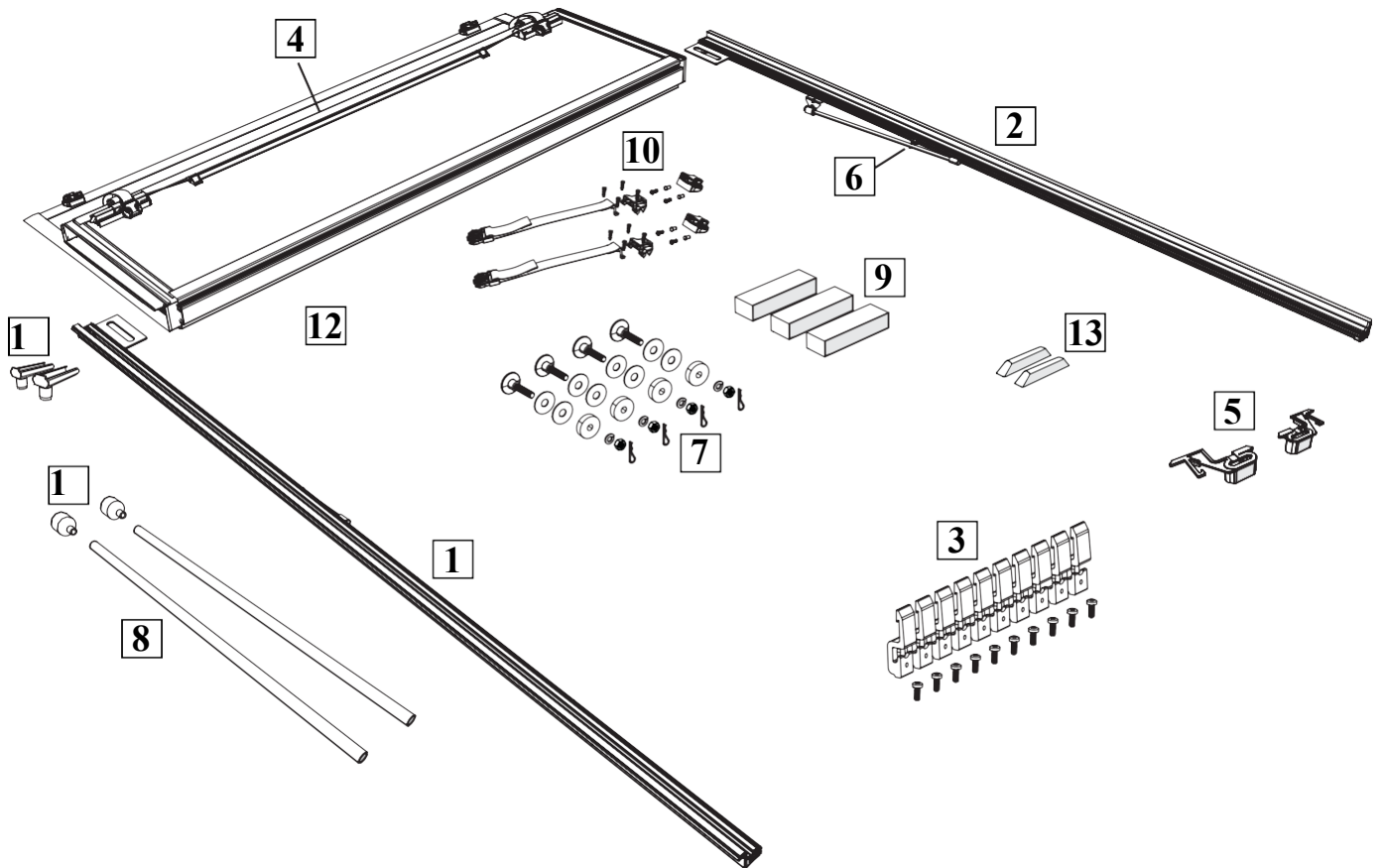

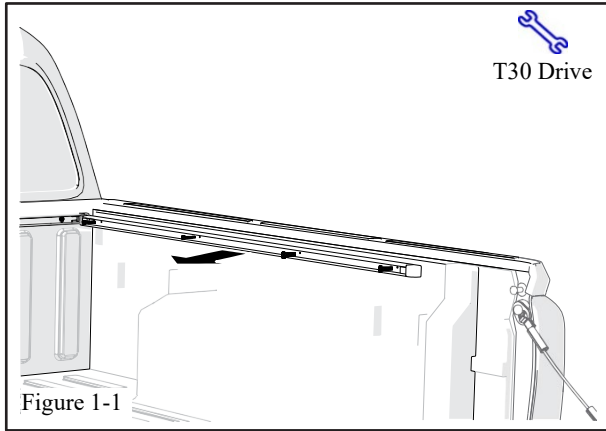

1. Remove Cargo Rails.

- (a) Remove the cargo rail fasteners and the rail. Keep both for later installation Figure (1-1).

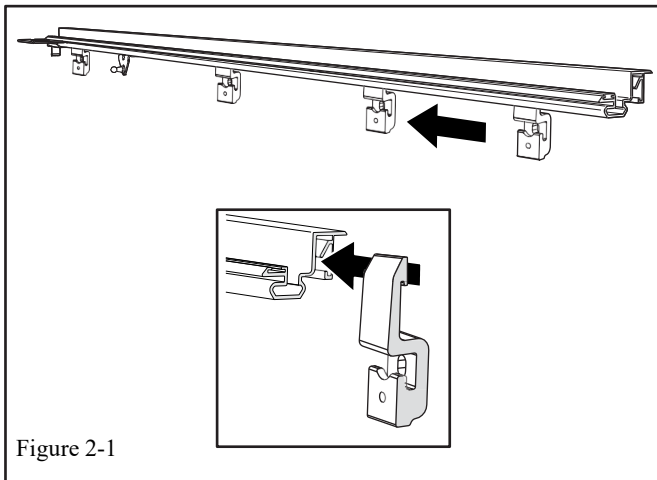

2. Install "S" Clamps.

- (a) Align the "S" clamps with the bed rail slot and insert into the rail. The clamps will match the truck bed holes from the cargo rail (Figure 2-1).

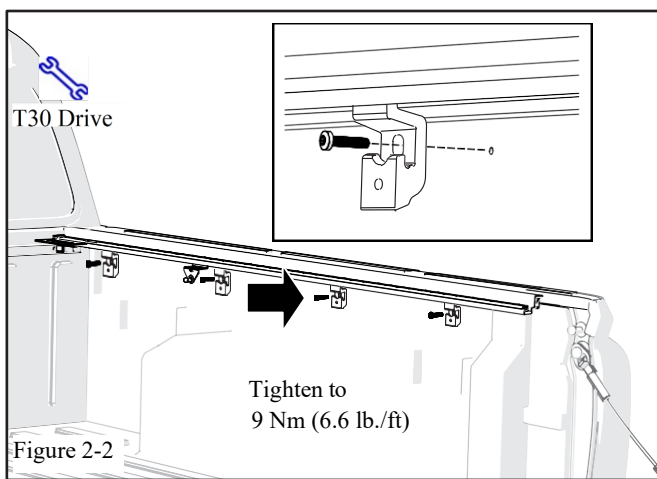

- (b) Mount the bed cover rail into the holes in the truck bed from the cargo rail. Reuse the fasteners from step 2. Before tightening, make the necessary adjustments to the rail so that is pushed forward and tight against the front bulkhead. Then tighten screws to the recommended torque of 9Nm (6.6 lb./ft) (Figure 2-2)

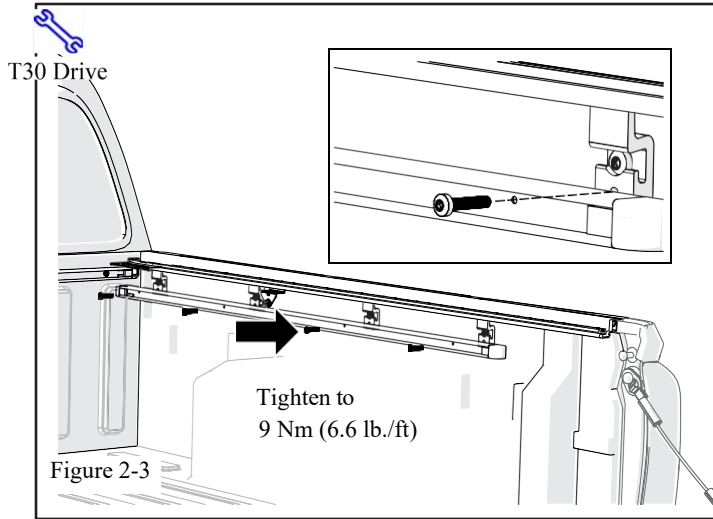

- (c) Mount the cargo rail to the 'S' clamps through the lower hole in the clamp. Use the screws from the hardware bag. Tighten to 9Nm (6.6 lb./ft) (Figure 2-3).

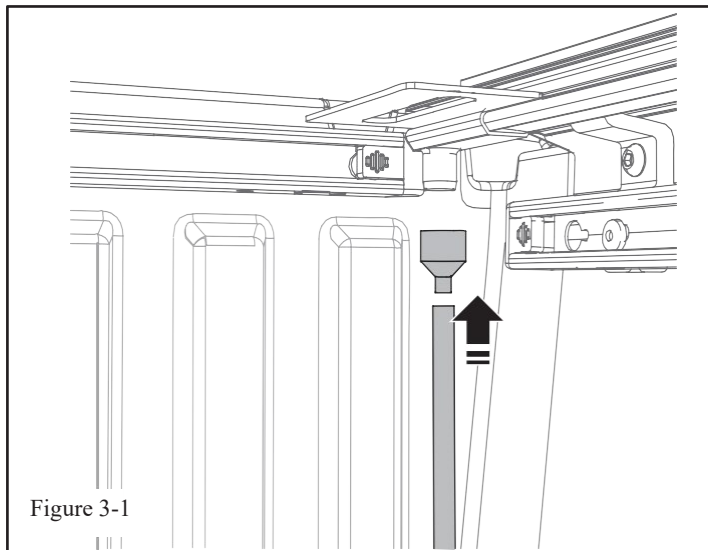

3. Install Drain Hoses.

- (a) Slide the drain hose onto the small end of the drain hose adapter until it stops sliding. (Fig. 3-1)

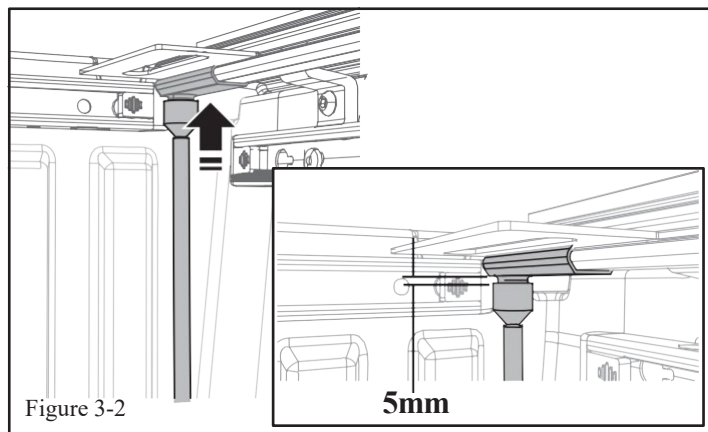

- (b) Slide the drain hose adapter with the drain hose onto the drain cap until it stops. (Figure 3-2) There should be approximately a 5mm gap between the top of the drain adapter and the bottom of the drain cap.

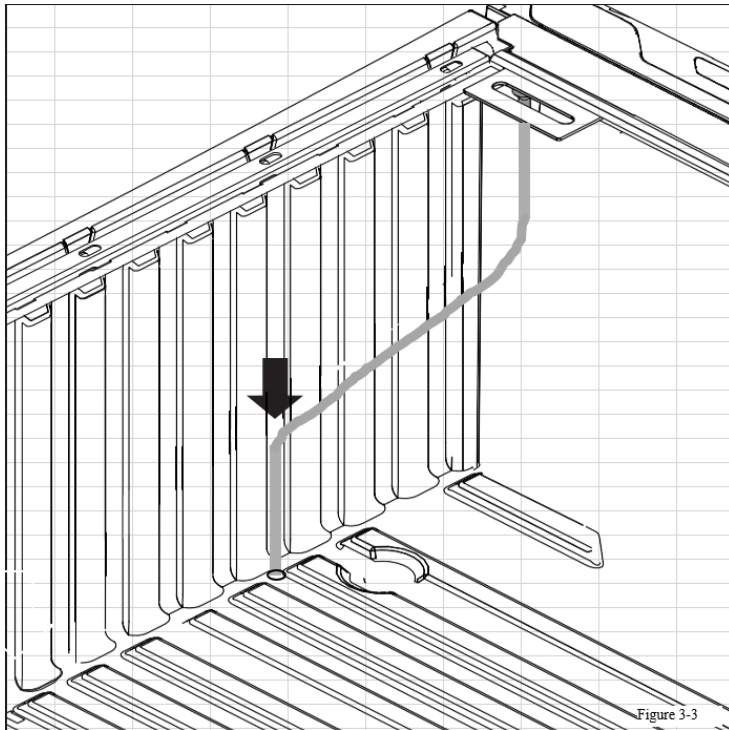

(c) Install the Drive side drain hose on the bottom of the truck bed through the hole nearest the bulkhead and nearest to the center of the bed. Mark the drive side drain hose anywhere between 50 to 80mm from the hose end to ensure the drain hose extends below the hole in the truck bed.

(d) Remove 275mm (10.8inch) to Passenger side drain tube ending.

Install Passenger side drain hose on the bottom of the truck bed, through the hole nearest the bulkhead and nearest towards the outboard side. (Fig 3-3)

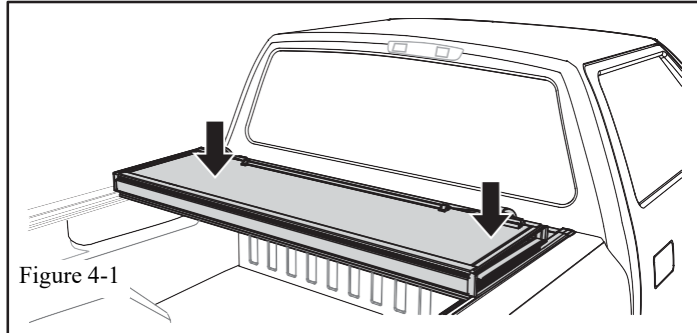

4. Install Bed Cover.

(a) Set the cover in the folded position on the bed cover rails toward the front of the bed at the cab (Figure 4-1).

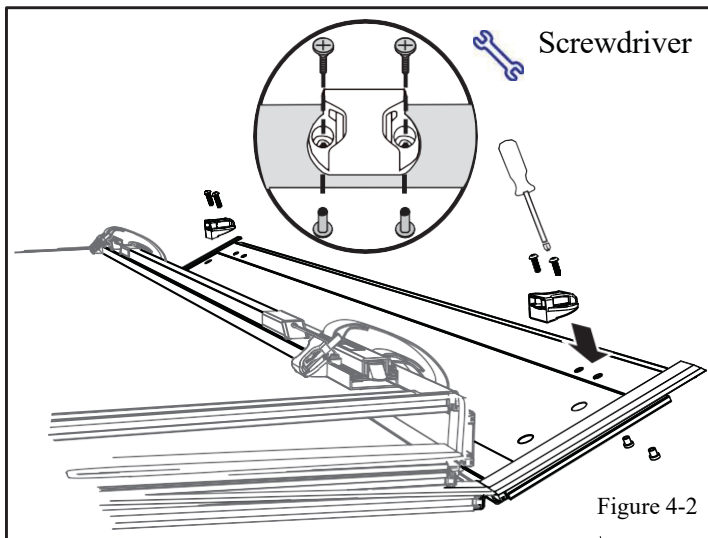

(b) Raise the front panel to install the two buckle ends into the pre-drilled holes with the provided machine screws and threaded posts (Figure 4-2).



DO NOT use a screw gun.



Securely tighten by hand with a screw driver.

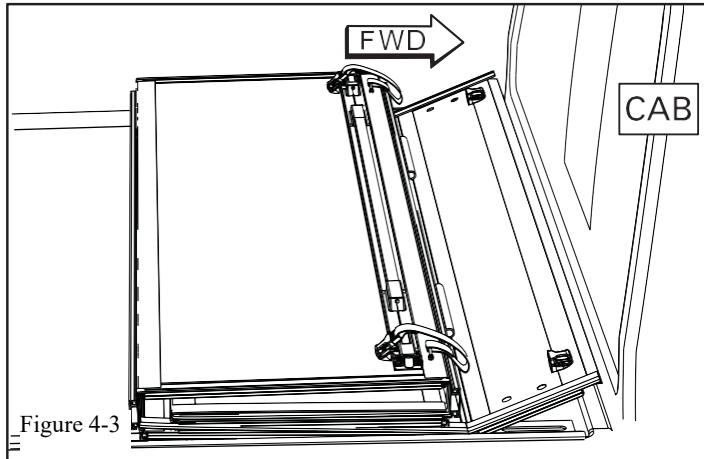

- (c) The front panel folds down over the slotted rail brackets. The front panel must sit just inside the bulkhead rail with the seal resting on top of the bulkhead. Fold the panel down and align it so it sits squarely on the rails and align the mounting holes with the slotted rail brackets (Figure 4-3).

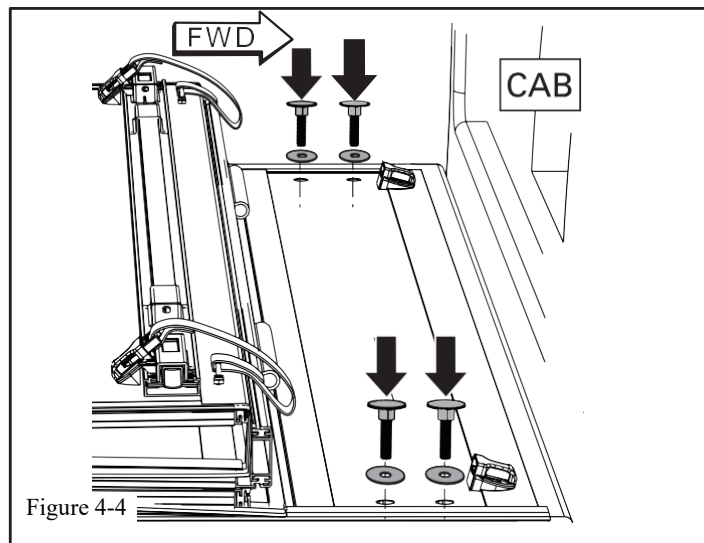

- (d) Insert the elevator bolts through a rubber washer, through the front panel and through the slotted bracket, one each side (Figure 4-4).

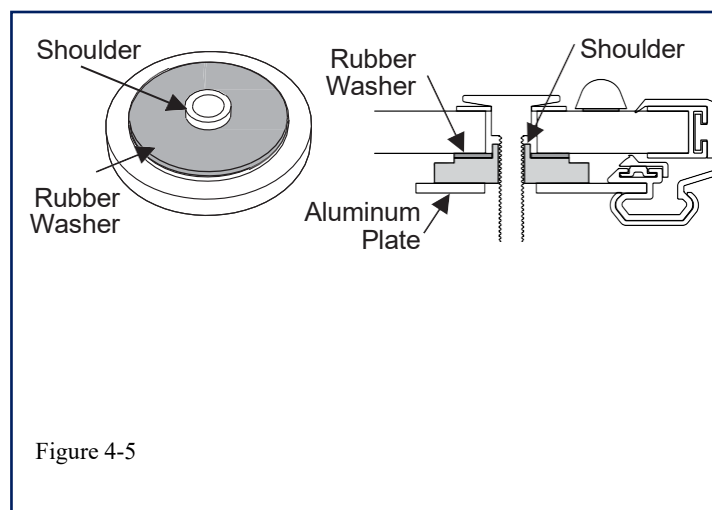

- (e) Position the aluminum spacer with the rubber washer so the elevator bolt will align and pass through both the spacer and the aluminum plate (Figure 4-5).
- ⚠ **NOTE: Make sure that the rubber washer fits over the shoulder of the spacer, as shown below.**
 - ⚠ **NOTE: Make sure the aluminum spacer is in the front and rear.**
 - ⚠ **NOTE: Make sure shoulder of spacer is positioned on top so it will go through the hole at the bottom of the panel.**

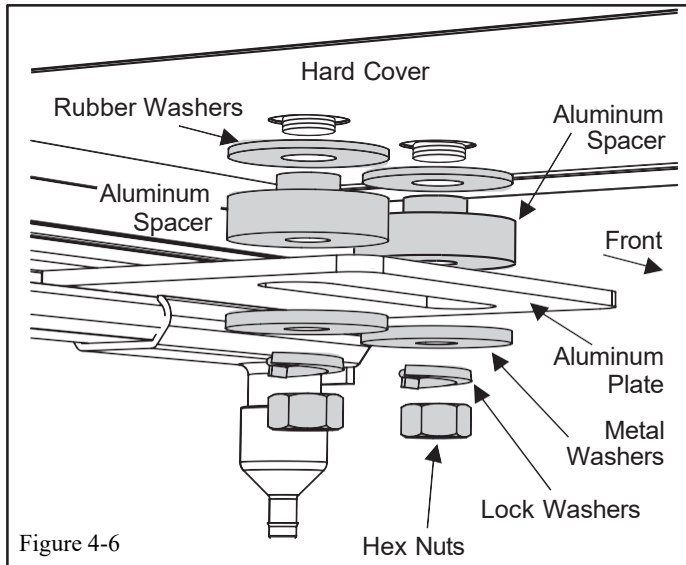

- (f) Assemble the metal washer and lock washer onto the elevator bolt from underneath the slotted aluminum plate. Then **loosely** install the hex nut (Figure 4-6).



Do not fully tighten.

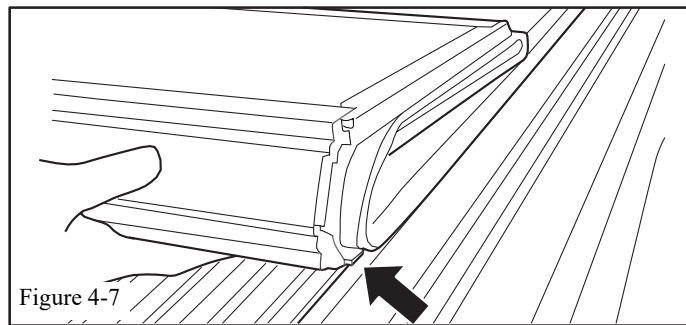

- (g) Unfold the cover toward the tailgate.  Make sure that the cover fits squarely between the rails (Figure 4-7).

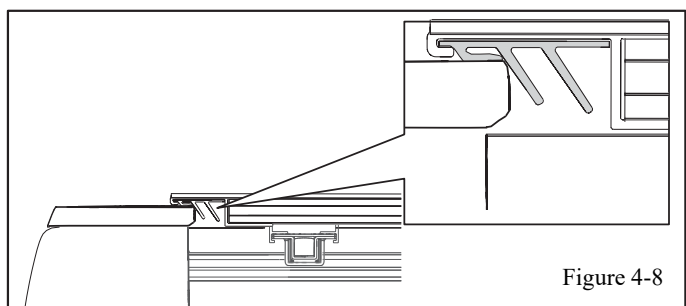

- (h) Close the tailgate and unfold the cover.  Check that the cover is parallel and square with the truck bed and bed rails. Adjust the cover until the rear seal has the rearward most fin on top of the tailgate and the second fin leaning on the edge of the tailgate, as shown. If not parallel or square, open the cover and loosen the cab clamps to reposition the cover. (Figure 4-8)

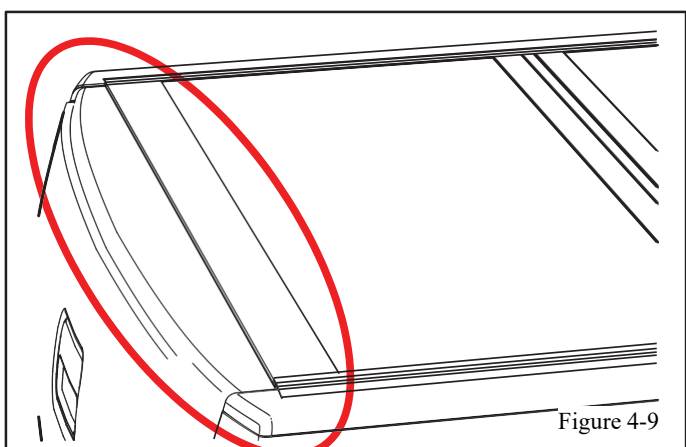

- (i) The rear edge of the cover and seal  should rest on top of the tailgate. (Figure 4-9)

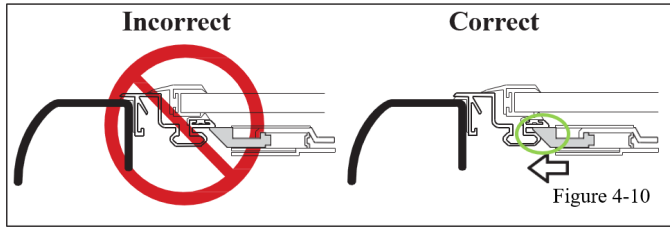

- (j) Check to see that the cover panel latches make proper contact with the side rails (Figure 4-10). 

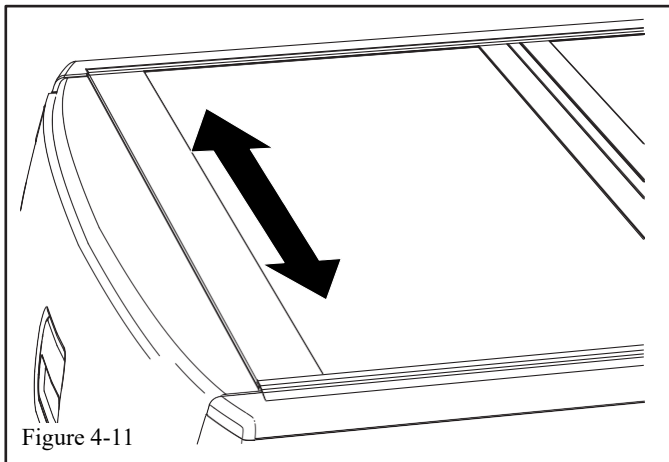

- (k) Adjust the cover side to side to make sure latches make proper contact with the rails. (Figure 4-11)

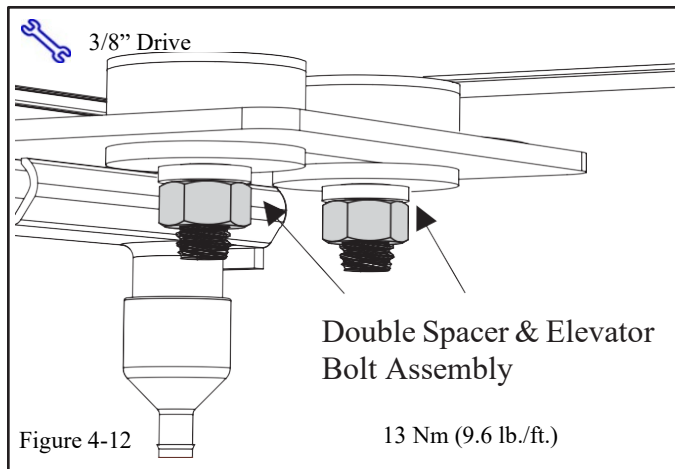

- (l) Carefully fold the cover forward and tighten the four (4) hex nuts to 13Nm (9.6 lb./ft.) and ensure that the lock washers are completely flat. (Figure 4-12)

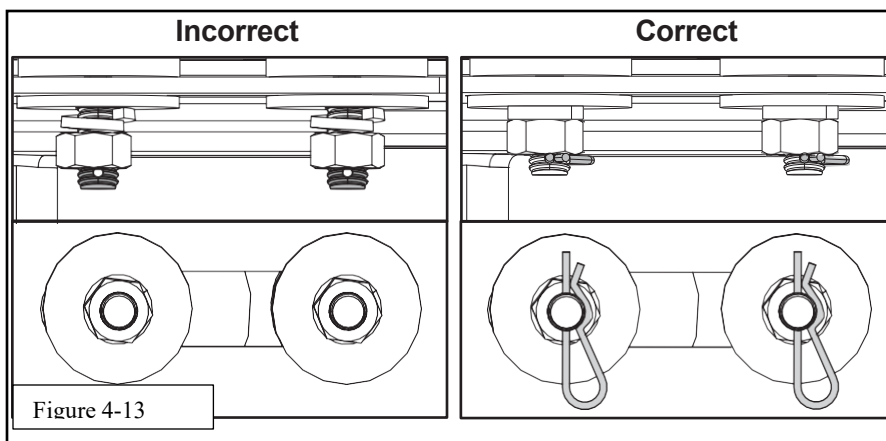

- (m) Secure the four (4) R-Clips (one through the hole of each elevator bolt).(Figure 4-13)

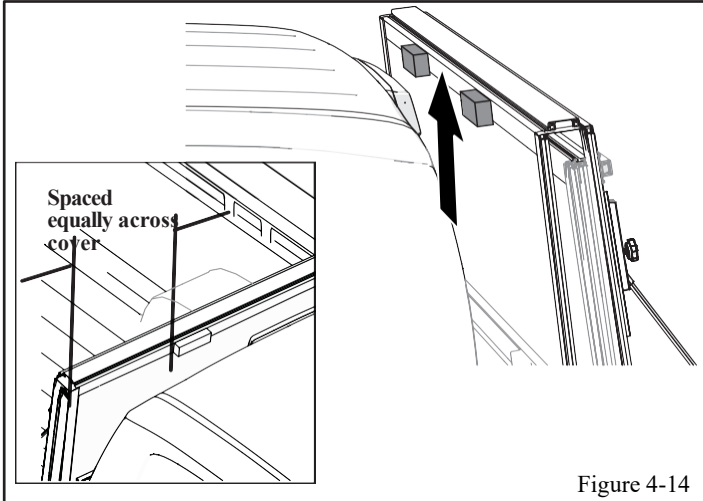

- (n) Install the two cab bumpers along the top edge of the cover equally spaced from left to right. (Figure 4-14)

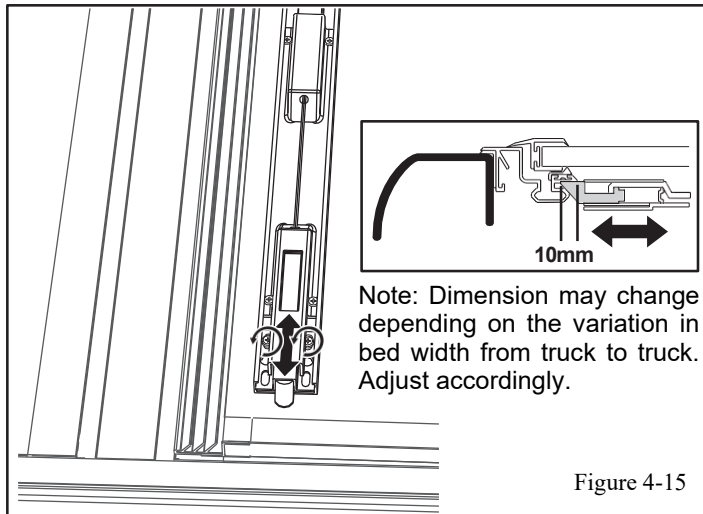

- (o) The cover panel latches can also be adjusted by loosening the mounting screws and moving the latch assembly out or in to better engage the cover side rail. Re-tighten the screws. (Figure 4-15)

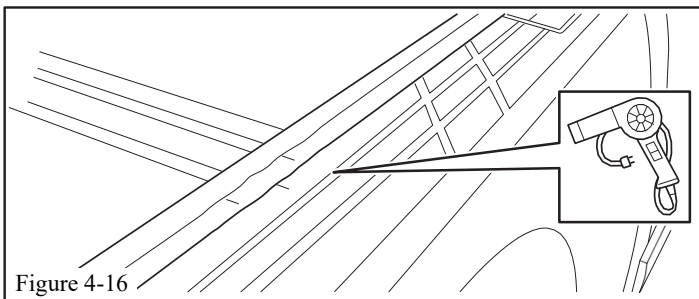

- (p) The side seals may appear wrinkled shortly after installing the cover, they will flatten out over time. Or, a hair dryer, heat gun or exposure to the sun will help to smooth them. (Figure 4-16)



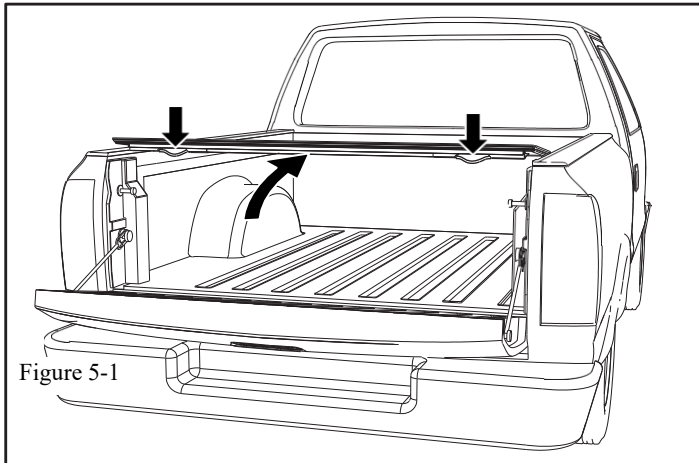

5. Tailgate Panel Operation.

TO CLOSE THE TAILGATE PANEL
The tailgate can be closed with the cover either up or down for universal operation.

TO OPEN THE TAILGATE PANEL
Open the tailgate and reach under the panel for the cable at either end of the panel. Pull the cable down to release both latches while lifting the panel.

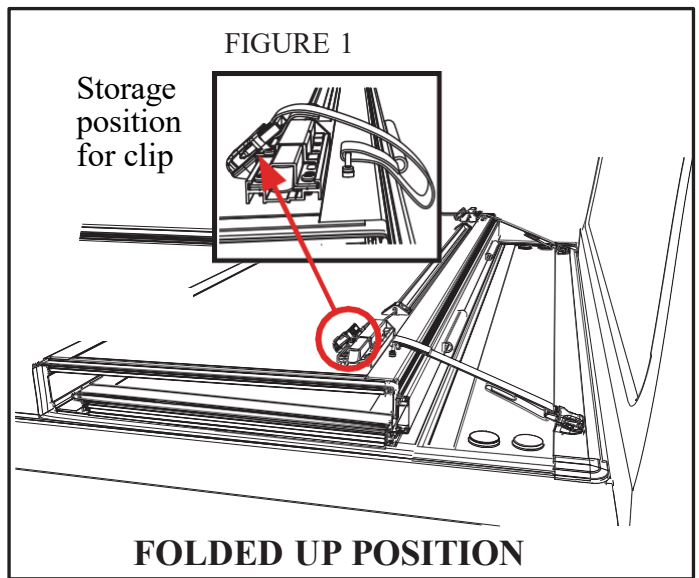

6. Tonneau Cover Positions While Operating Vehicle.

- (a) Prior to vehicle operation, tonneau cover **MUST** be properly secured.
- (b) **CLOSED POSITION**
All panels must be closed and **FULLY LATCHED** to tonneau side rail.
All panels must be flat and latches engaged.

<u>Check:</u>	<u>Look For:</u>
<p><u>Accessory Function Checks</u></p> <ul style="list-style-type: none"> <input type="checkbox"/> Confirm cover operation  <input type="checkbox"/> Rail Hardware Torque <input type="checkbox"/> <input type="checkbox"/> 	<hr/> <p>Ensure Tonneau cover folds/unfolds and latches/unlatches.</p> <p>Confirm hardware is torqued to 9 N*m (6.6 ft*lb)</p>
<p><u>Vehicle Function Checks</u></p> <ul style="list-style-type: none"> <input type="checkbox"/> Confirm tailgate operation <input type="checkbox"/> <input type="checkbox"/> 	<p>Tailgate should open and close without interference. Check both manual tailgate as well as power tailgate, if applicable.</p>
<p><u>Vehicle Appearance Check</u></p> <ul style="list-style-type: none"> <input type="checkbox"/> After accessory installation and removal of protective cover(s), perform a visual inspection. 	<p>Ensure no damage (including scuffs and scratches) was caused during the installation process. (For PPO installations, refer to TMNA Accessory Quality Shipping Standard.)</p>

